

Door Glass Adjustment

Info, images and part numbers are from The Fiero Store

The following instruction will aid in adjusting the door window in the door frame opening. Adjustment is useful when installing new door weatherstrips, door glass seals, window tracks or replacing the glass.

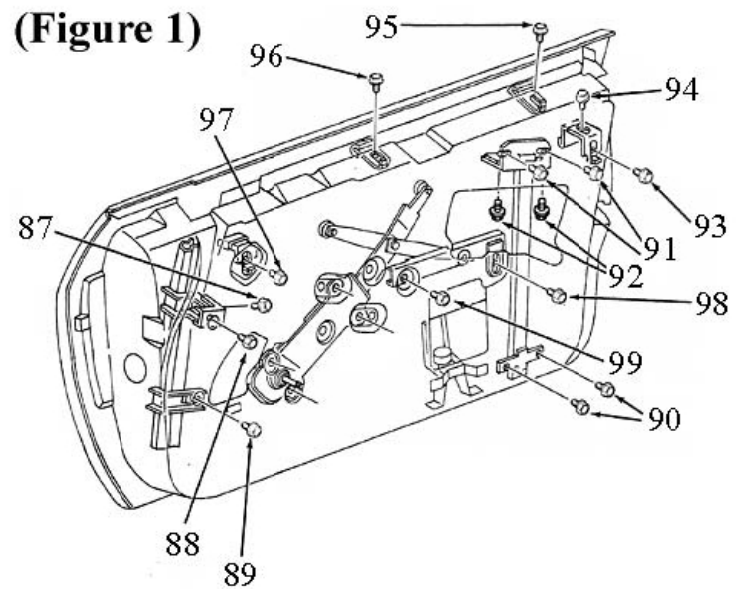
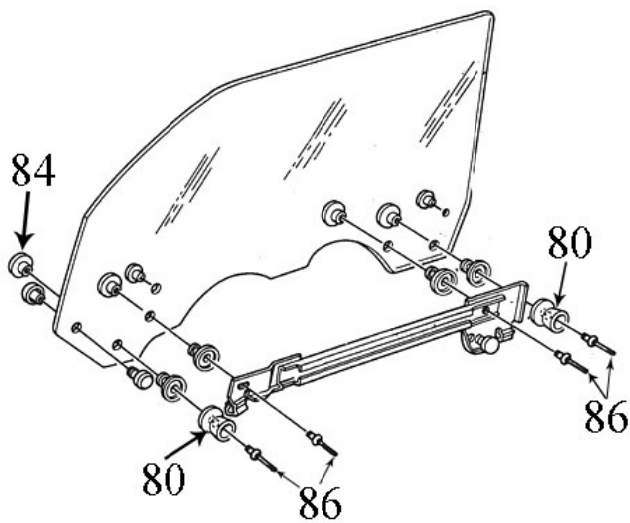

- #84 - Part #88107 Door glass track bushing
- #80 - Part #88025 Door window stop
- #86 - Part #88096 Door window rivet

- #87 - Front Retainer to Support
- #88 - Front Glass Run Channel to Inner Door
- #89 - Lower Front Glass Run Channel to Inner Door
- #90 - Lower Rear Cam Guide to Inner Door
- #91 - Rear Cam Support to Inner Door
- #92 - Rear Cam Guide to Support
- #93 - Rear Up-stop to Inner Door
- #94 - Rear Up-Stop to Support
- #95 - Rear Stabilizer to Inner Door
- #96 - Front Stabilizer to Inner Door
- #97 - Front Up-stop to Inner Door
- #98 - Rear Inner Panel Cam to Inner Door
- #99 - Front Inner Panel Cam to Inner Door

Window Rotation (see Figure 1)

- Loosen the up-stop bolts. (#97 & #93)
- Adjust the inner panel cam bolts. (#98 & 99)
- Adjust the window so that the upper edge of the glass is parallel with the roof side rail weatherstrip.
- Adjust the up-stops
- Tighten the attaching bolts

Window Upper Edge Inboard & Outboard (see Figure 1)

- Loosen the front retainer bolt. (#87)
- Loosen the rear cam guide to support bolts. (#92)
- Loosen the rear up-stop. (#93)
- Loosen the front & rear glass stabilizer screws (#95 & 96)
- Adjust the vertical guide & rear up-stop support in or out as required and tighten the attaching screws.

Window Too Far Forward or Rearward (see Figure 1)

- Loosen the front run channel bolts (#88 & 89).
- Loosen the rear cam guide assembly (#90 & 91).
- Align the glass in the correct up position.
- Tighten the upper bolt on the front run channel (#88).
- Tighten the upper bolts on the rear cam guide (#91).
- Lower the glass.
- Tighten the lower bolt on the front run channel (#89).
- Tighten the lower bolts on the rear cam guide (#90).

Window is Too High or Low in the Up Position (see Figure 1)

- Adjust the front & rear up-stop bolts (#93 & #97) as required and tighten the bolts.

Window Binds or has Inboard-Outboard Movement (see Figure 1)

- Loosen the glass stabilizers (#95 & 96).
- Place the glass in the half up position.
- Push the stabilizers against the glass with only enough pressure to eliminate the inboard-outboard movement.
- Tighten the glass stabilizers.
- Clean & lubricate the cam channels and rollers with Lubriplate (or equivalent).